



RESERVEDELE: NORDIC 390

1992 – 2002

SÆDER:

1. Standardsæde

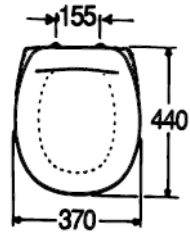

2. Sæde med soft close

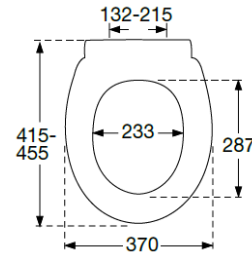

CISTERNE OG LÅG:

3. Cisternepakning

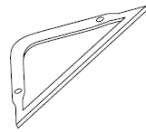

4. Cisternelåg



5. Trykkn. DUO / 6. ENKEL



7. Låg med trykplade

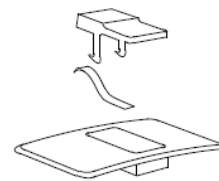

BUNDVENTIL:

8. Bundventil



9. Gummibold

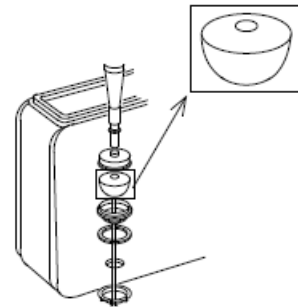

SVØMMEVENTIL:

10. Svømmeventil /

11. Membranhus

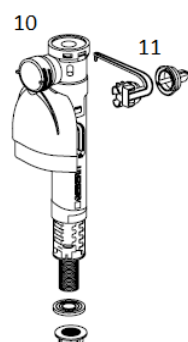

12. Komplet indmad

